

LIST OF SINTERED OIL PUMP GEROTORS WITH APPLICATIONS

DATED:
25-MAR-2022

S. NO.	AEL PART NO.	PART DESCRIPTION	NO. OF LOBES	SPECIFICATIONS	ECCENTRICITY	APPLICATION	CALCULATED DISPLACEMENT	DISPLACEMENT AT 1500 RPM & AT WORKING PRESSURE OF 5 BARS	
1	PMP/663	Inner Rotor (03 Lobes) with Keyway	3/4 Lobe	Flat to Tip	25.08mm	2.794mm	Oil Pumps for Perkins Engines in Massey Ferguson Tractors	0.406 cc/rev/mm OR 14.20 cc/rev	21.55 Liters/min.
				Inner Diameter	12.65mm				
				Height	35.40mm				
	Outer Diameter	42.00mm							
	Form Diameter	25.19mm							
PMP/664	Outer Rotor	Height (Max.)	35.40mm						
2	PMP/362	Inner Rotor (04 Lobes)	4/5 Lobe	Tip Diameter	29.67 mm	2.800mm	Oil Pumps for Perkins Engines in Massey Ferguson Tractor Model # 135	0.416 cc/rev/mm OR 7.91 cc/rev	11.90 Liters /min
				Inner Diameter	12.67 mm				
				Height	19.00 mm				
	Outer Diameter	40.90mm							
	Form Diameter	24.20mm							
PMP/149	Outer Rotor	Height	19.00mm						
3	PMP/611	Inner Rotor (04 Lobes)	4/5 Lobe	Tip Diameter	35.00mm	3.505mm	Oil Pumps for Sports Cars	0.575 cc/rev/mm OR 20.41 cc/rev	30.62 Liters/min.
				Inner Diameter	12.70mm				
				Height	35.50mm				
	Outer Diameter	49.10mm							
	Form Diameter	28.10mm							
PMP/612	Outer Rotor	Height	35.50mm						
4	PMP/141	Inner Rotor (04 Lobes)	4/5 Lobe	Tip Diameter	41.74 mm	3.800mm	Oil Pumps for Compressor for Buses	0.794 cc/rev/mm OR 7.65 cc/rev.	11.40 Liters/min.
				Inner Diameter	16.00 mm				
				Height	09.64 mm				
	Tip Diameter	41.74 mm							
	Inner Diameter	15.86 mm							
	Height	09.64 mm							
	Outer Diameter	58.00 mm							
	Form Diameter	34.24 mm							
	Height	09.64 mm							
PMP/143	Inner Rotor (04 Lobes) with 'D' Type ID								
PMP/142	Outer Rotor								
5	PMP/559	Inner Rotor (04 Lobes)	4/5 Lobe	Tip Diameter	43.30mm	4.000mm	Oil Pumps for Ford Transit vans	0.867 cc/rev/mm OR 29.40 cc/rev.	44.00 Liters/min.
				Inner Diameter	15.85mm				
				Height	34.00mm				
	Outer Diameter	61.03mm							
	Form Diameter	35.40mm							
PMP/560	Outer Rotor	Height	34.00mm						

Note: Above values of displacement in terms of liters per minute are approximations. These values will also depend on the Efficiency of the pump and the Viscosity of the liquid.

LIST OF SINTERED OIL PUMP GEROTORS WITH APPLICATIONS

DATED:
25-MAR-2022

S. NO.	AEL PART NO.	PART DESCRIPTION	NO. OF LOBES	SPECIFICATIONS	ECCENTRICITY	APPLICATION	CALCULATED DISPLACEMENT	DISPLACEMENT AT 1500 RPM & AT WORKING PRESSURE OF 5 BARS	
6	PMP/784	Inner Rotor (04 Lobes) with Key Way	4/5 Lobe	Tip Diameter	48.22mm	4.775mm	Industrial Applications	1.148 cc/rev/mm OR 14.58cc/rev.	43.74 Liters/min
				Inner Diameter	14.325mm				
				Height	25.4mm				
	PMP/785	Outer Rotor		Outer Diameter	66.713 mm				
				Form Diameter	38.80mm				
Height	25.4mm								
7	PMP/582	Inner Rotor (06 Lobes) with Spline ID	6/7 Lobe	Tip Diameter	54.63mm	3.560mm	Oil Pumps for Perkins Engines in Massey Ferguson Tractor Model # 's 375 & 385	1.06 cc/rev/mm OR 23.06 cc/rev	34.60 Liters/min.
				Inner Diameter	24.68mm				
				Height	21.75mm				
	PMP/583	Outer Rotor		Outer Diameter	69.65mm				
				Form Diameter	47.63mm				
Height	21.75mm								
8	PMP/674	Inner Rotor (06 Lobes)	6/7 Lobe	Tip Diameter	54.63mm	3.560mm	Oil Pump for Ford Tractor Model 6610-7000 Series	1.06 cc/rev/mm OR 47.38 cc/rev	71.00 Liters/min.
				Inner Diameter	12.65mm				
				Height	44.70mm				
	PMP/675	Outer Rotor		Outer Diameter	69.65mm				
				Form Diameter	47.65mm				
Height	44.70mm								
9	PMP/651	Inner Rotor (07 Lobes) with 'D' Shape Id	7/8 Lobe	Tip Diameter	16.95mm	1.065mm	Oil Pump for Honda Motorcycles 125cc engines	0.104 cc/rev/mm OR 1.24 cc/rev	1.87 Liters/min.
				Inner Diameter	9.00mm				
				Height	12.00mm				
	PMP/652	Outer Rotor		Outer Diameter	23.00mm				
				Form Diameter	14.95mm				
Height	12.00mm								
10	PMP/458	Inner Rotor (Eight Lobe)	8/9 Lobe	Tip Diameter	18.30mm	0.844mm	Oil Pumps for Automotive Applications	0.085 cc/rev/mm OR 0.585 cc/rev.	0.88 Liters/min
				Inner Diameter	9.00mm				
				Height	6.88mm				
	PMP/459	Outer Rotor		Outer Diameter	25.00 mm				
				Form Diameter	16.68mm				
Height	6.88mm								
11	PMP/685	Inner Rotor (08 Lobes) With Square & Half-Moon Key Way	8/9 Lobe	Tip Diameter	26.40mm	1.326mm	Oil Pumps for Automotive Applications	0.203 cc/rev/mm OR 1.29 cc/rev.	1.93 Liters/min
				Inner Diameter	12.70mm				
				Height	6.35mm				
	PMP/686	Outer Rotor		Outer Diameter	38.00 mm				
				Form Diameter	23.80mm				
Height	6.35mm								

Note: Above values of displacement in terms of liters per minute are approximations. These values will also depend on the Efficiency of the pump and the Viscosity of the liquid.

LIST OF SINTERED OIL PUMP GEROTORS WITH APPLICATIONS

DATED:
25-MAR-2022

S. NO.	AEL PART NO.	PART DESCRIPTION	NO. OF LOBES	SPECIFICATIONS	ECCENTRICITY	APPLICATION	CALCULATED DISPLACEMENT	DISPLACEMENT AT 1500 RPM & AT WORKING PRESSURE OF 5 BARS	
12	PMP/814	Inner Rotor (10 Lobes)	10/11 Lobe	Tip Diameter	60.40mm	2.500mm	Oil Pumps for Suzuki16100-82605	0.876 cc/rev/mm OR 7.87cc/rev.	10.51 Litres /min
				Inner Diameter	38.1mm				
				Height	8.00mm				
	Outer Diameter	73.9 mm							
	Form Diameter	55.5mm							
	Height	8.00mm							
PMP/815	Outer Rotor								

NOMENCLATURE OF GEROTORS (OIL PUMP)

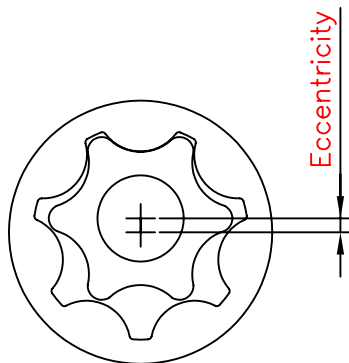
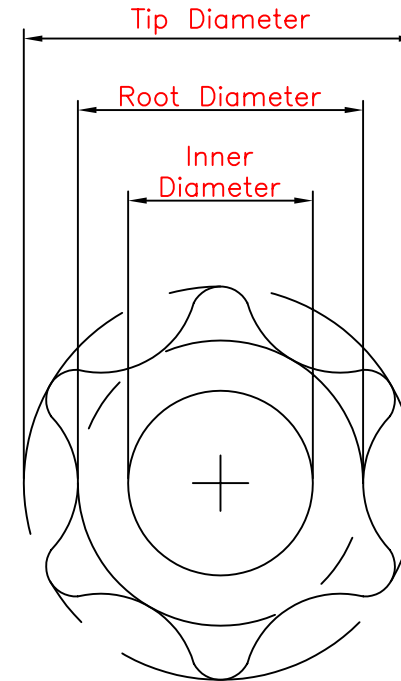
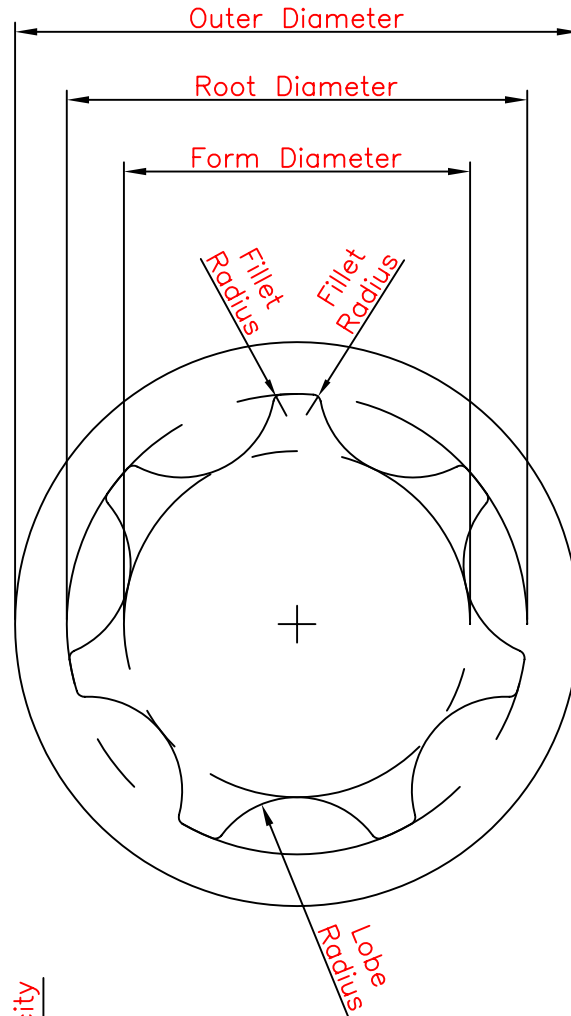

Tolerance symbols forms & positions			Units	Replacement for	Drawn by	Checked by	Approved by	Projection
Straightness —	Surface	Perpendicularity ⊥			I.A.Qazi			
Flatness ▨	Profile	Concentricity ◎						
Roundness ○	Parallelism //	Symmetry ≡	Scale	Material	Date	Date	Date	
Cylindricity Ⓞ	Position ⊕	Circular Runout Ⓢ	NTS		24-12-14			
Line Profile ⤴	Angularity ∟	Total Runout Ⓣ						
Application No.	Pos. Index	Alteration				DCR No.	Date	Approved
		Denomination:				Drawing No.		Index
		6/7 Lobe Rotor Set Nomenclature				C10 113		